

H101 (ISO7241-B)

开闭式液压快速接头

Close Type Hydraulic Quick Coupling

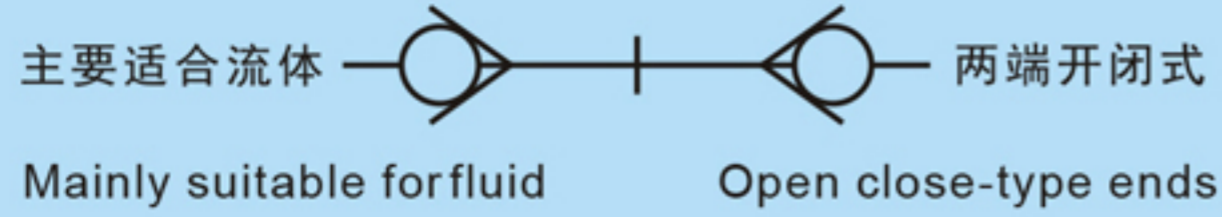

应用与特征 Application and features:

- 1、H101 系列液压快速接头主要用于建筑设备、森林设备、液压机械及石油设备等其他所需的液压应用。
- 2、接头断开时，阀芯自动闭合，防止泄漏，接头连接后，阀自动开启，在额定工作范围内，始终保持流体的畅通。
- 3、关键部位经过感应淬火，耐用性好。
- 4、符合ISO7241-B标准。
- 5、可互换产品：美国派克 60 系列、意大利快事达 ANV 系列、美国爱力克 FD45系列、美国汉森Hk系列。

- 1.The H101 Series hydraulic quick couplings are mainly used for construction equipment, forest equipment, hydraulic machinery and oil equipment and other required hydraulic applications.
- 2.Poppet valves are available to prevent uncoupled leakage .Poppet valves open automatically when coupled within rated working pressure to keep the flow expeditely.
- 3.Critical parts are hardened for durability.
- 4.H001 series conforms to the standard of ISO7241-B.
- 5.Compatible with PARKER 60 Series, FASTER ANV Series AEROQUIP FD45 Series and HANSEN HK Series.

技术规范 Specifications

规格(英寸)Body Size(in)	1/4	3/8	1/2	3/4	1
额定压力Rated pressure(PSI)	5000	4000	4000	3000	3000
额定流量Rated flow(GPM)	3	6	12	28	50
温度范围(标准密封圈)Temperture range(std seals)	-20°C~+80°C				
标准密封圈材料为氟橡胶 Standard seal material is	Flouorocarbon				

压降 Pressure Drop-in PSID

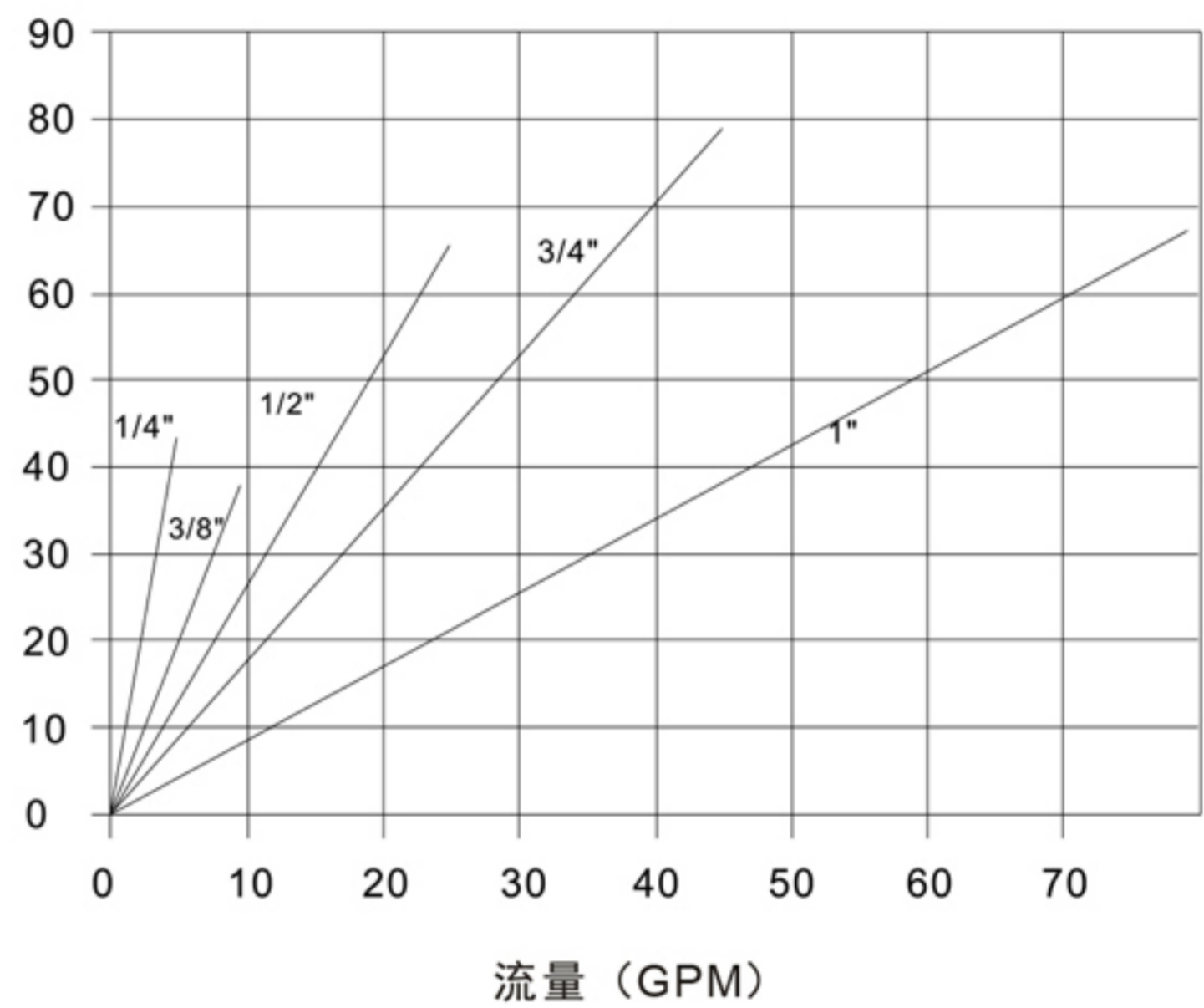

母插座 SOCKET

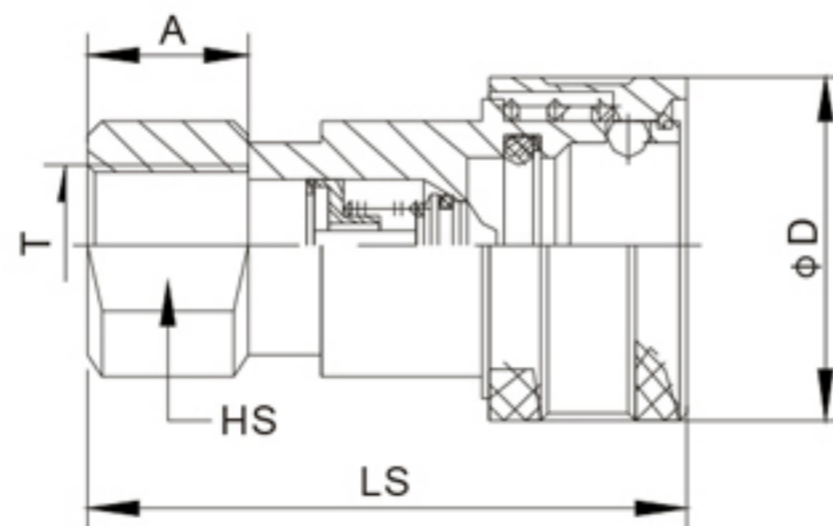

Part No .	LS	φD	HS	A	T
H101-02SF	58	28.5	19	13	G1/4 NPT1/4
H101-03SF	65	35	22	14	G3/8 NPT3/8
H101-04SF	74	44.5	28.5	18	G1/2 NPT1/2
H101-06SF	92	54	36	22	G3/4 NPT3/4
H101-08SF	105	65	41	23	G1 NPT1/2

公插头 PLUG

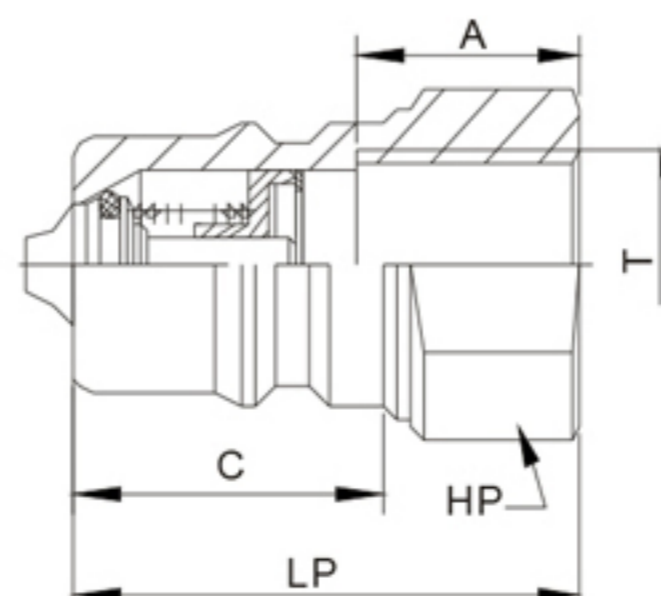

Part No .	LP	C	HP	A	T
H101-02PF	35.5	22.8	19*6角	13	G1/4 NPT1/4
H101-03PF	40	25	22*6角	14	G3/8 NPT3/8
H101-04PF	46.5	28	27*6角	18	G1/2 NPT1/2
H101-06PF	56	36	36*6角	22	G3/4 NPT3/4
H101-08PF	65	45	41*6角	23	G1 NPT1